

Terminal Tractor Information Bulletin



Subject: T2 Cab Grounding Enhancement			
Product: Medium Terminal Tractor	Bulletin # SB18TI0092	Date: 8-Aug-2018	Pages: Page 1 of 6
To: All Kalmar Sales Companies		From: Medium Terminal Tractor Product Support	

Units Affected: Kalmar Ottawa T2 terminal tractors

Possible Situation: Electrical grounding issues isolated to cab (skeleton) ground studs.

Solution: A service kit to address ground studs threads contaminated with paint overspray and possible poor ground connections. The kit includes new brass nuts and orientation of ground lugs and ring terminals onto grounding studs. Service kit part number; **SK8795**.

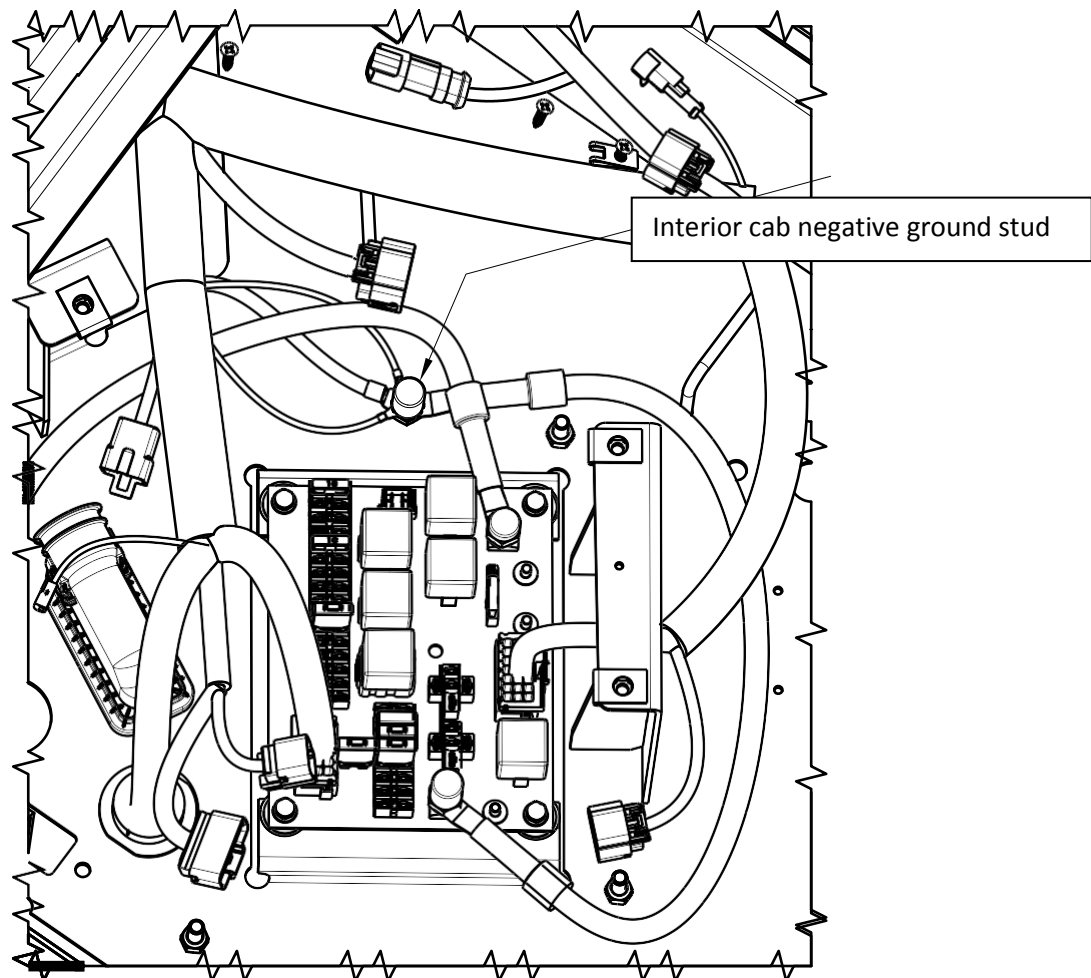

Terminal Tractor Information Bulletin



Subject: T2 Cab Grounding Enhancement			
Product: Medium Terminal Tractor	Bulletin # SB18TI0092	Date: 8-Aug-2018	Pages: Page 2 of 6
To: All Kalmar Sales Companies		From: Medium Terminal Tractor Product Support	

CAUTION: PROPER LOCKOUT / TAGOUT PROCEDURES AS WELL AS PERSONAL SAFETY PROCEDURES AND DEVICES INCLUDING EYE PROTECTION ARE REQUIRED.

- Park truck on a level surface
- Set park brake
- Chock wheels
- Shut off engine
- Lockout / tagout

Interior cab negative ground stud:

- Disconnect battery cables from batteries
- Remove data terminal plate to gain access to interior cab power board. Locate cab (skeleton) ground stud.

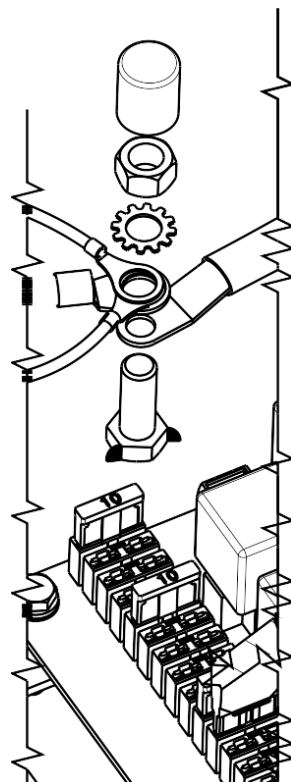

Terminal Tractor Information Bulletin



Subject: T2 Cab Grounding Enhancement			
Product: Medium Terminal Tractor	Bulletin # SB18TI0092	Date: 8-Aug-2018	Pages: Page 3 of 6
To: All Kalmar Sales Companies		From: Medium Terminal Tractor Product Support	

- Remove black rubber cap, nut, star grounding washer and all ground lugs and ring terminals from ground stud
- Discard rubber cap, nut and star washer
- Using a 3/8-16 rethreading die, clean the threads to ensure proper connection with steel cab structure. Remove all paint overspray from grounding stud.
- Inspect cable lugs and ring terminals crimp. Perform cable / terminal tug test
- Install first brass jam nut (p/n: CTT00021168 jam nut) on ground stud. Torque-tighten to 125 in-lb.

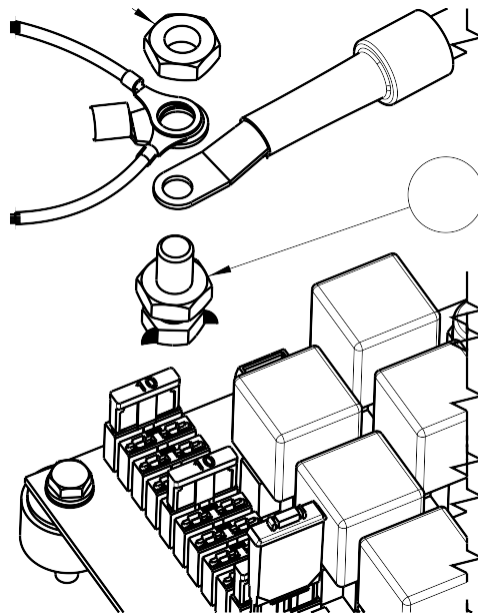

- Position all removed ground lugs and ring terminals according to size; biggest first – smallest last
- Install the second brass jam nut (p/n: CTT00021168 jam nut) on ground stud. Torque-tighten to 110 in-lb.
- Reinstall the data terminal plate onto cab power board

Terminal Tractor Information Bulletin



Subject: T2 Cab Grounding Enhancement			
Product: Medium Terminal Tractor	Bulletin # SB18TI0092	Date: 8-Aug-2018	Pages: Page 4 of 6
To: All Kalmar Sales Companies		From: Medium Terminal Tractor Product Support	

Cab tilling - up:

 **DANGER**

Do NOT work under the raise cab before ensuring that the cab safety prop is locked in position. Failure to heed this danger could result in severe personal injury or death.

- Remove the vehicles front panel access cover
- The cab tilt control switch and cable lanyard for safety prop are located on the frame rail between the hydraulic tank and rear wheel.

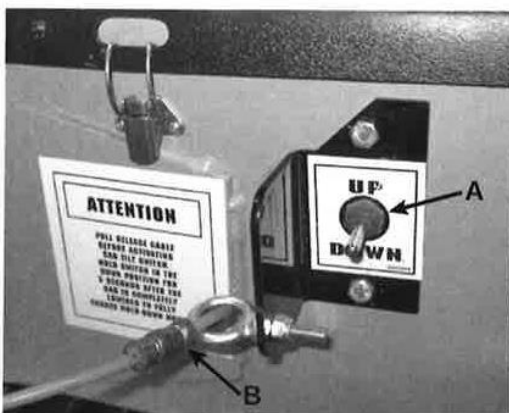

Cab Tilt Control Switch and Lanyard
A – Cab Tilt Control Switch
B – Safety Prop Release Cable

Cab Tilt Safety Prop – An additional mechanical safety device is used to ensure that the cab cannot be inadvertently lowering. The cab safety prop is similar to a hood prop in function; but instead of holding the hood (or cab in this case), it acts a solid arm locking the hydraulic tilt cylinder in the extended (cab-tilted) position. It is cable-operated from the tilt operation station where the control switch is located.

Terminal Tractor Information Bulletin



Subject: T2 Cab Grounding Enhancement			
Product: Medium Terminal Tractor	Bulletin # SB18TI0092	Date: 8-Aug-2018	Pages: Page 5 of 6
To: All Kalmar Sales Companies		From: Medium Terminal Tractor Product Support	

- Release cab safety prop with cable lanyard before activating the cab tilt control switch.
- **Raise cab and ensure safety prop lock bar is in locked position over driver side tilt cylinder supporting full weight of cab**

Exterior cab negative ground stud:

- Locate the exterior cab ground stud on the cab firewall above the engine.

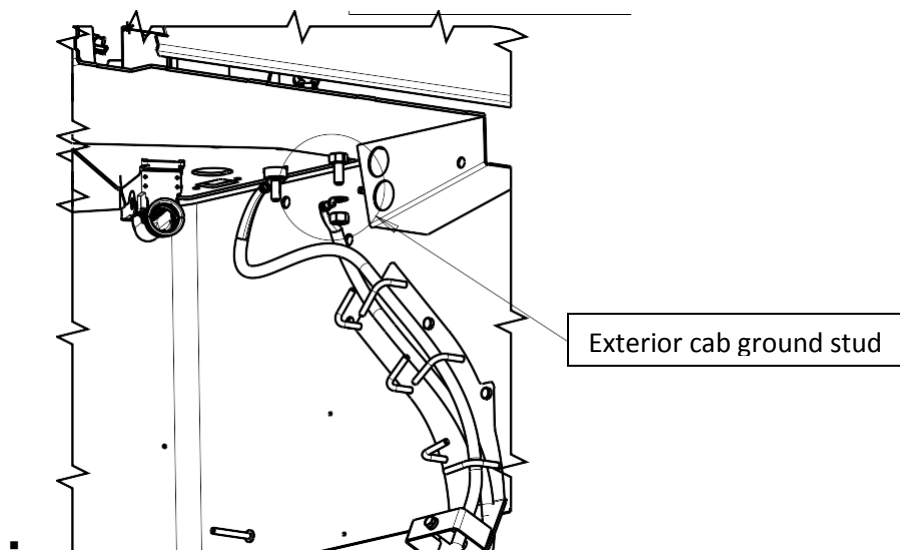

- Remove the nut from exterior cab ground stud. Remove cable and ring terminals from ground stud. Discard nuts
- Using a 3/8-16 rethreading die, clean ground stud threads to ensure proper connection with steel cab structure. Check for paint overspray on grounding stud. Remove as required
- Install first brass nut (p/n: CTT00021167 nut) on ground stud. Torque-tighten against cab structure to 160 in-lb.

Terminal Tractor Information Bulletin



Subject: T2 Cab Grounding Enhancement			
Product: Medium Terminal Tractor	Bulletin # SB18TI0092	Date: 8-Aug-2018	Pages: Page 6 of 6
To: All Kalmar Sales Companies		From: Medium Terminal Tractor Product Support	

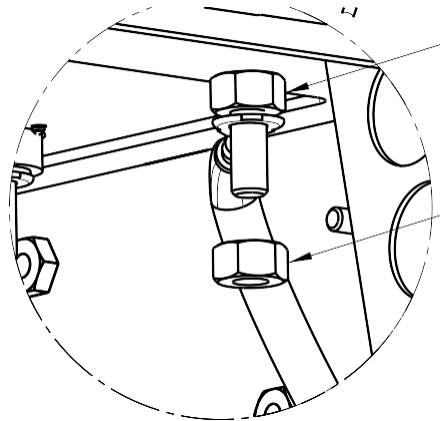

- Inspect cable lugs and ring terminals crimp. Perform cable / terminal tug test
- Position all ground lugs and ring terminals according to size; biggest first – smallest last
- Install the second brass nut (p/n: CTT00021167 nut) on ground stud.
Torque-tighten to 145 in-lb.
- Visually inspect to ensure no part of negative cables are touching, contacting or abrading positive cables.

Cab tilling - down:

- Release cab safety prop with cable lanyard before activating the cab tilt down control switch.
- Lower cab and ensure mechanical cab latch is fully engaged, cab is in locked position
- Reinstall front panel access cover
- Inspect battery terminals, clean as required, connect battery cables to batteries. Apply a film of dielectric grease to battery terminals
- Return truck to service

Tools:

- 3/8 – 16 rethreading die